

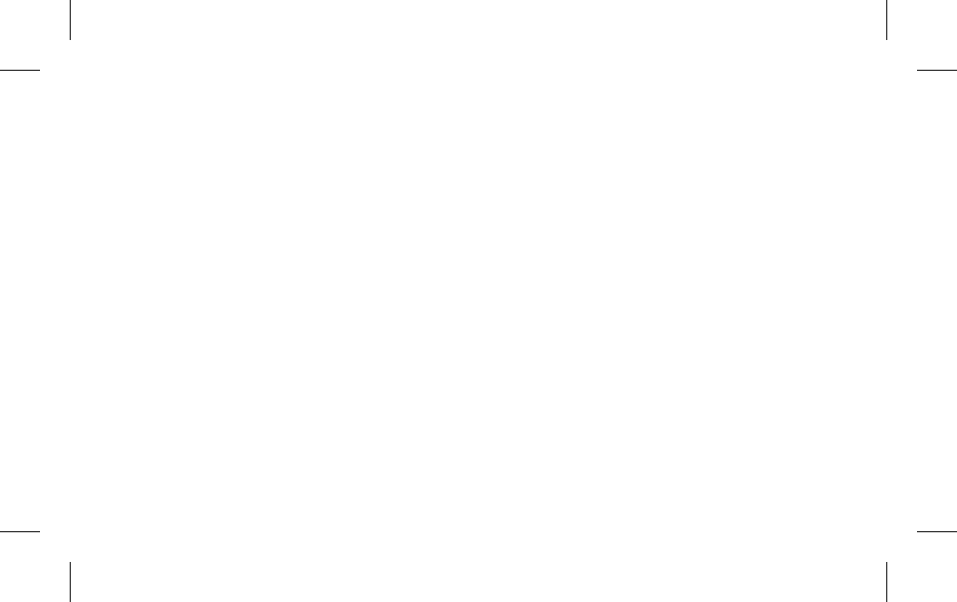

LORENZ

MANUALE DI ISTRUZIONI
Calibro Ronda 3540D



DESCRIZIONE CONTATORI E PULSANTI

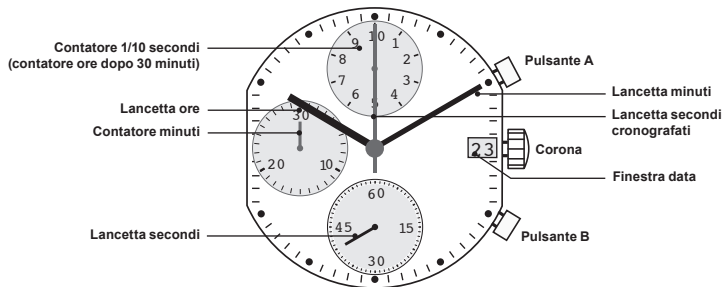

REGOLAZIONE ORA

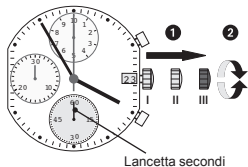

- 1) *Tirare la corona in posizione III (l'orologio si ferma)
- 2) Ruotare la corona fino all'ora desiderata
- 3) *Premere la corona riportandola alla posizione I

N.B.

*Per regolare l'ora al secondo:

- 1) la corona deve essere estratta quando la lancetta secondi è in posizione 60" (I). Una volta impostate ore e minuti la corona deve essere riportata in posizione I al secondo preciso.

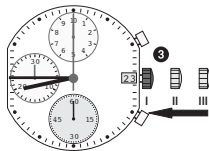

REGOLAZIONE DELLA DATA

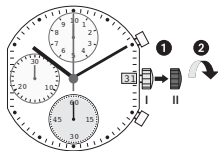

- 1) Tirare la corona in posizione II (l'orologio continua a funzionare)
- 2) Ruotare la corona in senso antiorario fino alla data desiderata
- 3) Riportare la corona in posizione I

Attenzione

Se la regolazione della data viene effettuata tra le ore 20:30 e le 24:00 la data deve essere messa al giorno successivo.

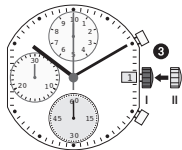

REGOLAZIONE DATA / ORA

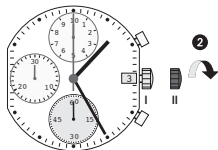
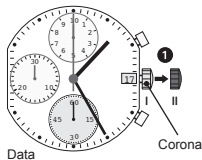

IT. 6

Esempio:

- Data/ora del disegno: **17** / 1:25 AM
- Data/ora da impostare: **4** / 8:30 PM

- 1) Tirare la corona in posizione II (l'orologio continua a funzionare).
- 2) Ruotare la corona in senso antiorario fino alla data antecedente a quella da impostare **3**.

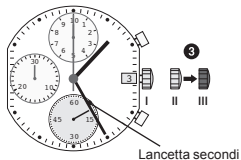

- 3)* Portare ora la corona in posizione III (l'orologio si arresta).
- 4) Ruotare la corona sino alla data desiderata 4
- 5) ** Ora continuare a ruotare la corona fino all'ora desiderata (20:30)
- 6) Premere la corona fino alla posizione I

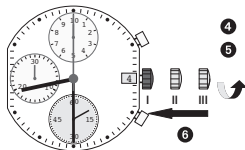

Attenzione

* Per regolare l'orologio al secondo fare riferimento alla sezione Regolazione ora

** Osservare i cicli AM/PM dell'orologio

CRONOGRAFO: FUNZIONI BASE (AVVIO / ARRESTO / AZZERAMENTO)

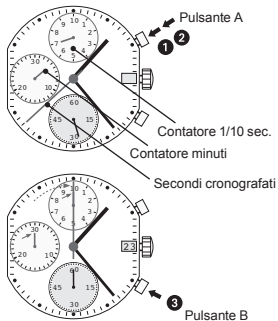

Esempio:

1) Avvio: premere il pulsante A

2) Arresto: per fermare il conteggio premere nuovamente il pulsante A e leggere le 3 lancette del cronografo: 4 min. 38 sec. - 7/10 sec.

3) Azzeramento: premere il pulsante B per riportare in posizione 0 le 3 lancette del cronografo.

CRONOGRAFO: TEMPO ACCUMULATO

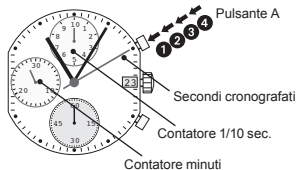

Esempio:

- 1) Avvio: inizio conteggio
- 2) Arresto: (15 min 5 sec. dopo il punto 1)
- 3) Riavvio: (il conteggio riparte)
- 4) *Arresto: (13 min 5 sec. dopo il punto 3)
= 28 min 10 sec
(Visualizzazione del tempo totale cumulato)
- 5) Azzeramento:

Le 3 lancette del cronografo sono ritornate in posizione 0.

Attenzione

*Dopo il punto 4, per proseguire il conteggio del tempo premere il pulsante A. (Riavvio / Arresto, Riavvio / Arresto ...)

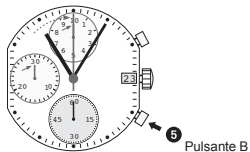

CRONOGRAFO: TEMPI INTERMEDI E INTERVALLO

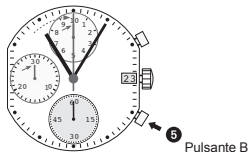
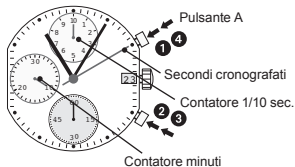

Esempio:

1) Avvio: (conteggio avviato)

2) Visualizzazione intervallo:

10 min.: 10 sec. (il conteggio continua sullo sfondo)

*3) Verifica conteggio: le 3 lancette cronografiche si spostano rapidamente sul conteggio effettivo

4) Arresto: visualizzazione del tempo finale

5) Azzeramento: le 3 lancette cronografiche si collocano sulla posizione 0

Attenzione

* E' possibile visualizzare altri tempi intermedi o intervalli premendo il pulsante B (visualizzazione intervallo/tempo misurato/....)

REGOLAZIONE LANCETTE CRONOGRAFICHE IN POSIZIONE 0

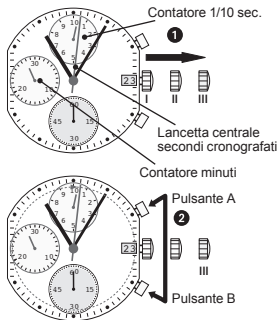

Esempio:

Una o più lancette cronografiche potrebbero non essere nella loro corretta posizione 0 e devono essere regolate (es: dopo un cambio pila).

- 1) Portare la corona in posizione III (le tre lancette cronografiche sono sulla corretta/errata posizione 0)
- 2) Premere il pulsante A e B contemporaneamente per almeno 2 secondi. La lancetta secondi cronografati ruota di 360° ---> la modalità correzione è attivata)

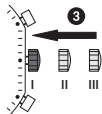

IT. 12

- Regolazione lancetta secondi cronografati

Avanzamento singolo: premere singolarmente A

Avanzamento veloce: tenere premuto A

- Regolazione lancetta successiva con pulsante B

- Regolazione lancetta contatore 1/10 sec. (posizione h. 6)

- Regolazione lancetta

Avanzamento singolo: premere singolarmente A

Avanzamento veloce: tenere premuto A

- Regolazione lancetta successiva con pulsante B

- Regolazione contatore minuti (posizione h. 9)

Avanzamento singolo: premere singolarmente A

Avanzamento veloce: tenere premuto A

- Regolazione lancetta con pulsante B

3) Riportare la corona in posizione I.

La regolazione delle lancette come sopra indicato può essere effettuata in qualsiasi momento.

Batteria: modello 384 (diametro 7,9 mm x 3,6 mm / SR 41 SW)

Precisione: +20/-10 secondi al mese







LORENZ

INSTRUCTIONS MANUAL

Ronda 3540D caliber

GB. 16

DESCRIPTION OF THE DISPLAY AND CONTROL BUTTONS

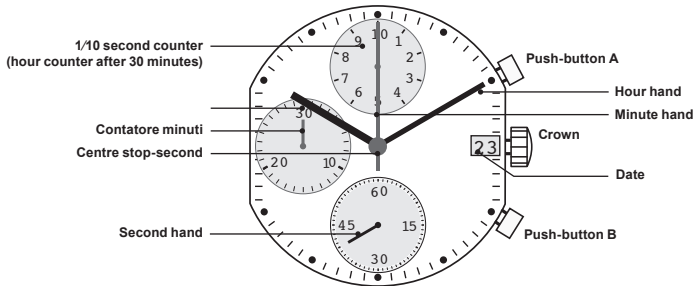

SETTING THE TIME

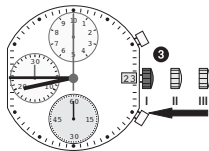
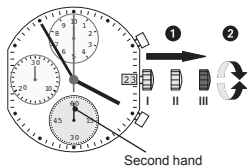

- 1) *Pull out the crown to position III (the watch stops).
- 2) Turn the crown until you reach the correct time 8:45.
- 3) *Push the crown back into position I.

Please note:

*In order to set the time to the exact second, the crown must be pulled out when the second hand is in position «60» (I). Once the hour and minute hands have been set, the crown must be pushed back into position I at the exact second.

SETTING THE DATE (QUICK MODE)

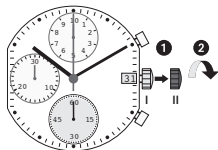

- 1) Pull out the crown to position II (the watch continues to run).
- 2) Turn the crown anticlockwise until the correct date 1 appears.
- 3) Push the crown back into position I.

Please note:

During the date changing phase between 08.30 PM and 12 PM; the date must be set to the date of the following day.

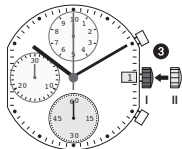

SETTING THE DATE/TIME

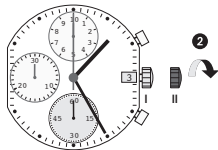
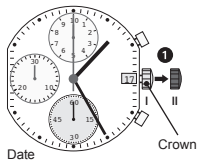

GB. 20

Example:

- Date / time on the watch: **17** / 1:25 AM
- Present date / time: **4** / 8:30 PM

- 1) Pull out the crown to position II (the watch continues to run).
- 2) Turn the crown anticlockwise until yesterday's date appears **3**.

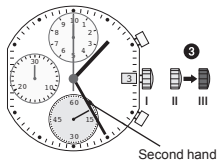

Second hand

- 3)* Pull out the crown to position III (the watch stops).
- 4) Turn the crown until the correct date 4 appears.
- 5) ** Continue to turn the crown until the correct time 8:30 PM appears.
- 6) Push the crown back into position I.

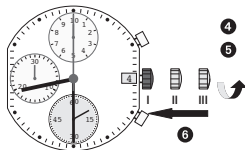

Please note

* To set your watch to the exact second, please refer to the chapter entitled "setting the time".

** Please observe the AM/PM clock rhythm.

CHRONOGRAPH: BASIC FUNCTION (START / STOP / RESET)

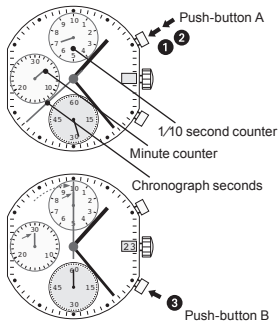

Example:

- 1) Start: Press push-button A.
- 2) Stop: to stop the timing, press push-button A once more and read the 3 chronograph counters: 4 min / 38 sec / 7/10 sec
- 3) Zero positioning: Press push-button B. (The 3 chronograph hands will be reset to their zero positions).

CHRONOGRAPH: ACCUMULATED TIMING

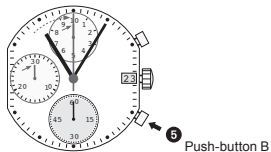
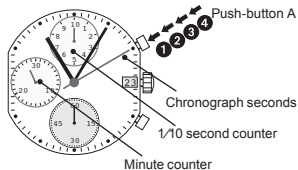

Example:

- 1) Start: (start timing)
- 2) Stop: (e.g. 15 min 5 sec following 1)
- 3) Restart: (timing is resumed)

4) *Stop: (e.g. $\frac{13 \text{ min } 5 \text{ sec}}{= 28 \text{ min } 10 \text{ sec}}$)

(The accumulated measured time is shown)

Reset: \curvearrowright

- 5) The 3 chronograph hands are returned to their zero positions.

Please note:

*Following 4, the accumulation of the timing can be continued by pressing push-button A
(Restart / Stop, Restart / Stop, ...)

CHRONOGRAPH: INTERMEDIATE OR INTERVAL TIMING

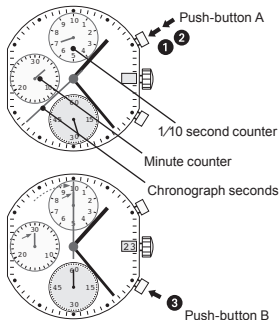

GB. 24

Example:

1) Start: (start timing)

2) Display interval: e.g. 10 minutes 10 seconds (timing continues in the background)

3) Making up the measured time: (the 3 chronograph hands are quickly advanced to the ongoing measured time).

4) Stop: (Final time is displayed)

5) Reset:

The 3 chronograph hands are returned to their zero position

Please note:

* Following 3, further intervals or intermediates can be displayed by pressing push-button B (display interval / make up measured time, ...)

ADJUSTING THE CHRONOGRAPH HANDS TO ZERO POSITION

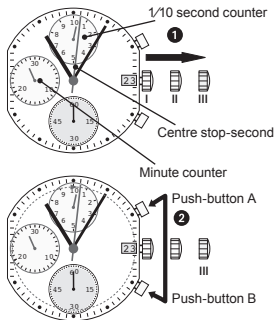

Example:

One or several chronograph hands are not in their correct zero positions and have to be adjusted (e.g. following a battery change).

1) Pull out the crown to position III (all 3 chronograph hands are in their correct or incorrect zero position).

2) Keep push-buttons A and B depressed simultaneously for at least 2 seconds (the centre stop-second rotates by 360° ---> corrective mode is activated).

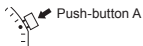

Push-button A



Push-button B

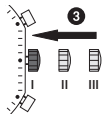

GB. 26

- Adjusting the centre stop second

Single step A 1x short

Continuous A long

- Adjusting the next hand B

- Adjusting the 1/10 second counter hand (6h position)

Single step A 1x short

Continuous A long

- Adjusting the next hand B

- Adjusting the minute counter (9h position)

Single step A 1x short

Continuous A long

- Adjusting the next hand B

3) Returning the crown to position I

Termination of the chronograph hands adjustment (can be carried out at any time).

Battery type: 384 (diameter 7.9 mm x 3.6 mm / SR 41 SW)

Accuracy: +20 / -10 seconds per month



ISTLZ3540D

WWW.LORENZ.IT